

Hole location for traditional fires with gas components

STEP 1

Clear firebox

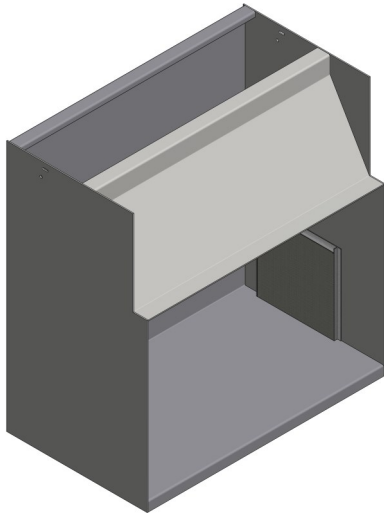

Note:
To be drilled on site.

STEP 2

Front View

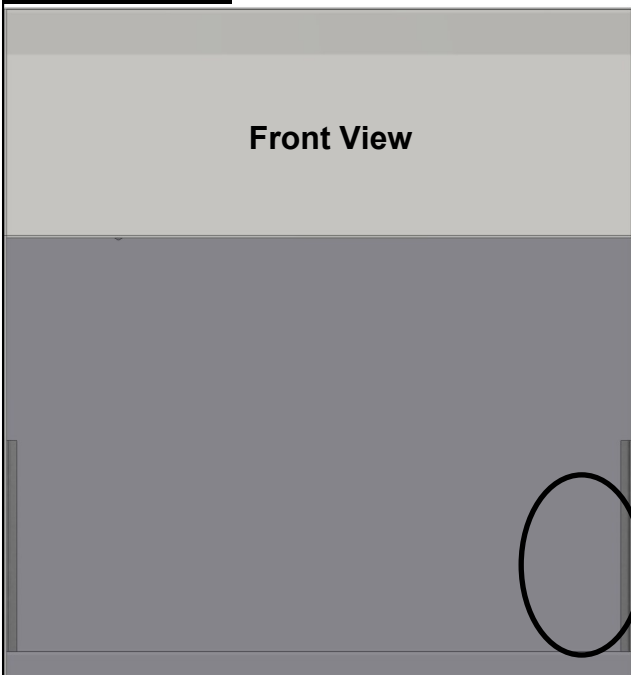

HOLE LAYOUT FOR RAIL BURNER

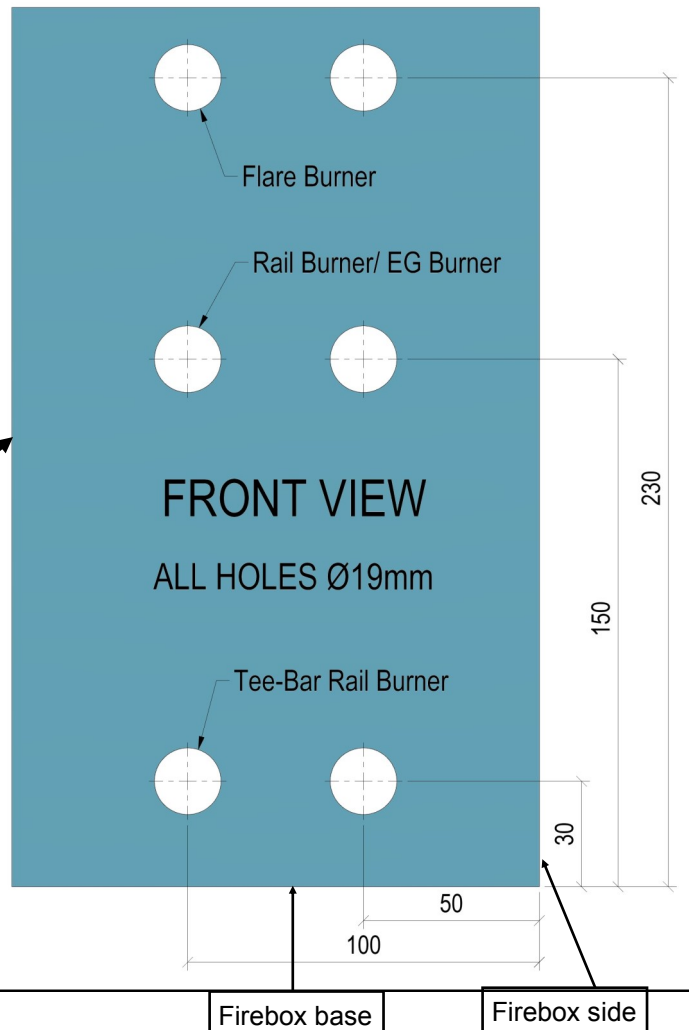

Cut holes as per layout.

Note: cut to required gas unit i.e. Flare burner, Rail Burner, SG/EG Burner or Tee-Bar Rail Burner.

Note: this layout is for right side gas feed, for left side feed mirror the image.

STEP 3

Install necessary bricks as required for the gas unit. Put on the supplied rubber grommets.
Feed the gas pipe and electronic wires to the gas unit and connect it up as per the specs.

STEP 4

Install the rest of the bricks around the gas unit and finish up the installation of the firebox.